



# TERRAMET

## PROJECT MANAGEMENT CONSULTANCY

The Intelligence Behind Every Build

# Our Resource-Based Approach



## Qualified Professionals

*Experienced team deployed based on project requirements and complexity.*



## Efficient Coordination

*Seamless collaboration across all disciplines and stakeholders.*



## Continuous Monitoring

*Real-time tracking of project progress and performance metrics.*



## Structured Control

*Effective management of cost, time, and quality parameters.*

# Project Planning & Design Coordination

## Project Planning & Pre-Construction

- *Review of project brief and client requirements*
- *Coordination with design consultants*
- *Preparation and validation of project schedules*
- *Preliminary budget review and cost planning*
- *Identification of potential risks and constraints*

## Design Coordination

- *Review of drawings for completeness and coordination*
- *Ensuring interdisciplinary alignment (Architectural, Structural, MEP)*
- *Identification and mitigation of design conflicts*
- *Facilitation of design review meetings*

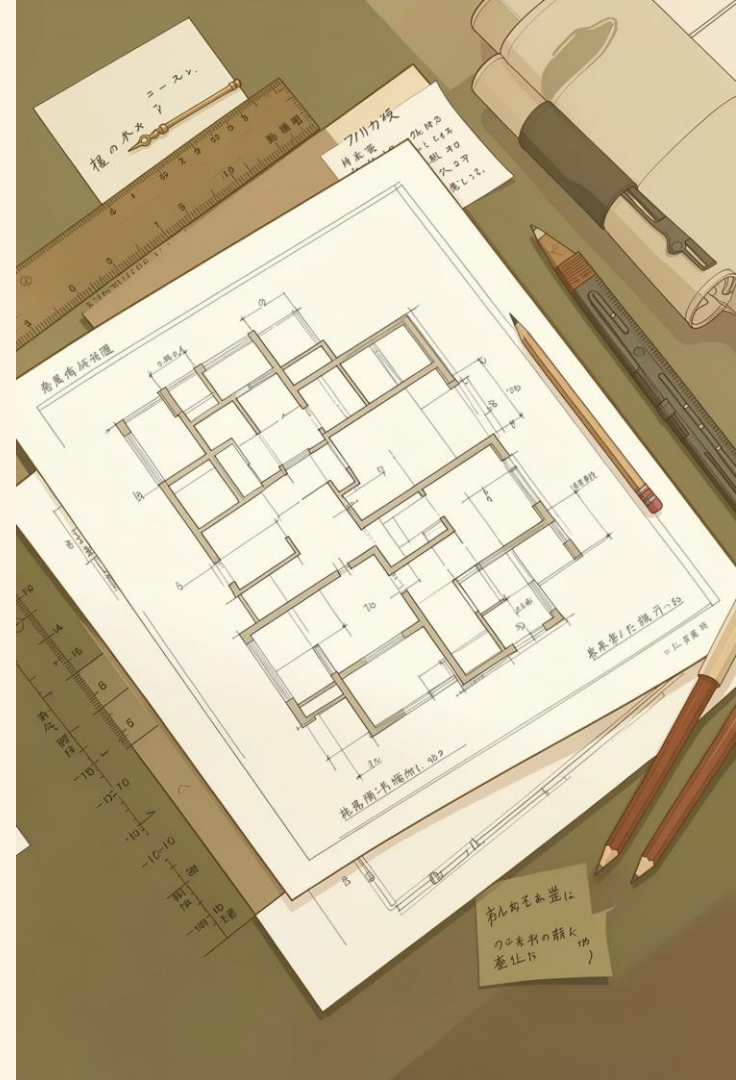

# Procurement & Construction Management



## Vendor Identification

*Assistance in vendor and contractor selection*



## Tender Preparation

*Preparation and review of tender documents*



## Bid Evaluation

*Technical and commercial assessment*



## Contract Award

*Recommendation and finalization support*

---

## Construction Management

- *Overall site coordination and supervision*
- *Monitoring of contractor performance*
- *Tracking progress against approved schedules*
- *Identification and resolution of execution bottlenecks*
- *Conducting regular site review meetings*

Qualitätssicherung  
Checklist

# Cost Control & Quality Assurance

## Cost Control & Commercial Management

- *Monitoring project costs against approved budgets*
- *Verification of contractor bills and certifications*
- *Change order management and cost impact analysis*
- *Prevention of cost overruns through proactive control*

## Quality Assurance & Control

- *Implementation of quality control procedures*
- *Inspection of works as per approved specifications*
- *Monitoring adherence to standards and best practices*
- *Reduction of rework through systematic checks*

# Time, Safety & Documentation Management

## Time Management

- *Development and tracking of detailed project schedules*
- *Identification of delays and mitigation planning*
- *Ensuring adherence to milestone timelines*

## Safety Management

- *Monitoring compliance with safety standards*
- *Promoting safe construction practices at site*
- *Coordination with contractors on safety protocols*

## Documentation & Reporting

- *Periodic progress reports (daily/weekly/monthly)*
- *Maintenance of project records and documentation*
- *MIS reporting for client decision-making*
- *Meeting minutes and action tracking*

# Project Close-Out Process



## Completion Monitoring

*Tracking completion and snag resolution*



## Testing & Commissioning

*Coordination for testing and commissioning activities*



## Final Documentation

*Support in final handover documentation*



## Contract Closure

*Closure of contracts and final accounts*

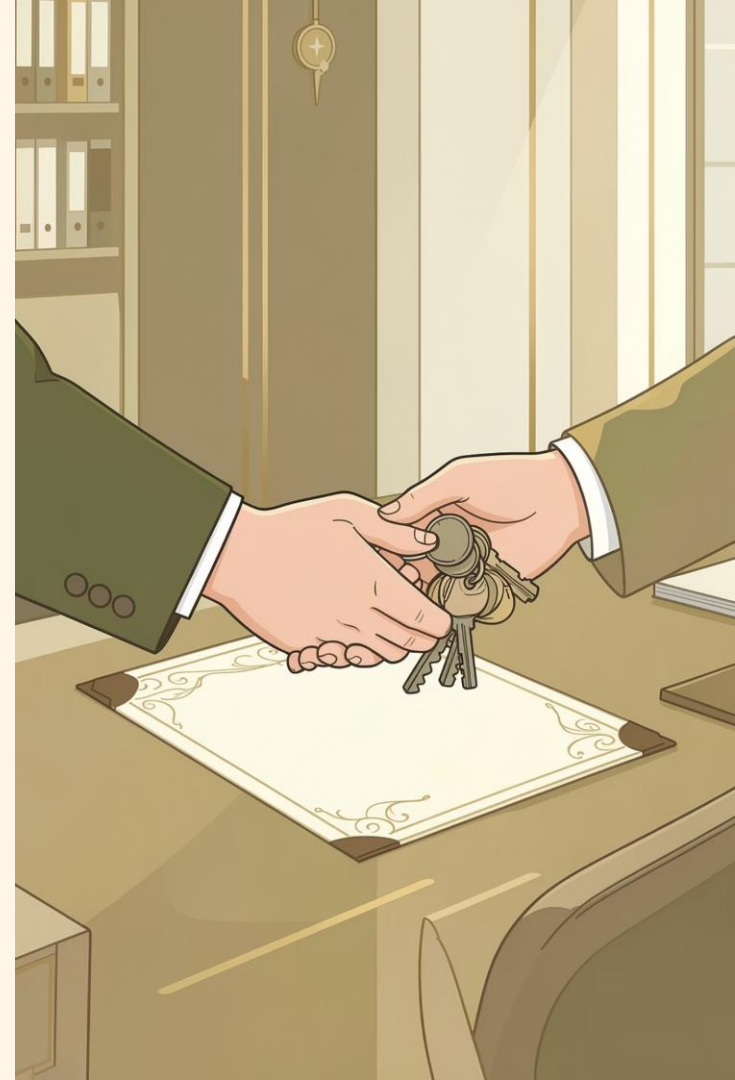

# Cost & Time Benefits

8-12%

## Cost Savings

*Optimized procurement strategy through competitive bidding and technical evaluations*

## Time & Schedule Efficiency

- *Improved project scheduling and milestone tracking*
- *Early identification of delays with proactive mitigation measures*
- *Reduction in project overruns through structured planning*
- *Faster decision-making enabled by real-time reporting systems*

100%

## Budgetary Control

*Strict budgetary control through continuous cost monitoring and variance analysis*

## Financial Control

- *Elimination of redundant expenditure by avoiding duplication and scope overlaps*
- *Effective change management ensuring controlled financial impact of variations*

# Quality, Risk & Coordination Benefits



## Quality Assurance

*Robust QA/QC systems aligned with project specifications. Minimization of rework through systematic inspections and approvals.*



## Risk Management

*Early risk identification and mitigation planning. Compliance with applicable codes, standards, and safety regulations.*



## Single-Point Coordination

*Framework between Client, Consultants, and Contractors. Structured communication and reporting systems.*

---

## Resource & Material Management

- *Reduction in material wastage and pilferage through monitoring and control mechanisms*
- *Optimized utilization of labor and equipment*
- *Efficient inventory planning and tracking*
- *Improved site productivity through streamlined workflows*

# Our Value Proposition

## Ownership-Driven Execution

*Proactive approach to project delivery with full accountability*

## Process-Oriented Systems

*Structured project control systems ensuring disciplined execution*

## Data-Backed Decisions

*Real-time monitoring and data-driven decision support*

## Commitment to Excellence

*Dedicated focus on time, cost, and quality objectives*

*We ensure that the client can focus on strategic decisions while we manage the complexities of execution.*



# Reach us at

1st Floor, BSR Trendz Building,  
Plot No 10, Greenland Colony,  
Madhav Reddy Nagar, Gachibowli,  
Hyderabad, Telangana, 500032.

[www.terrametinfra.com](http://www.terrametinfra.com)

[query@terrametinfra.com](mailto:query@terrametinfra.com)